

ELECTRIC TILLER EXPLODED VIEW

KS 1000T E

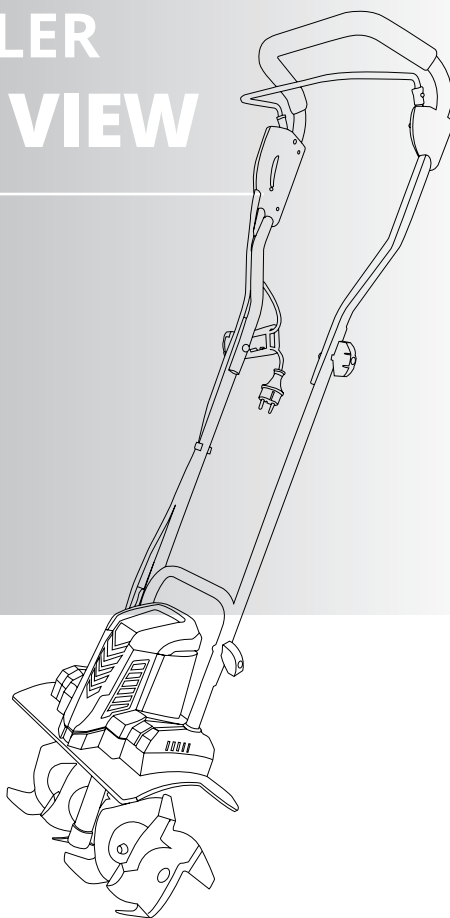

TRADITIONELLE DEUTSCHE QUALITÄT

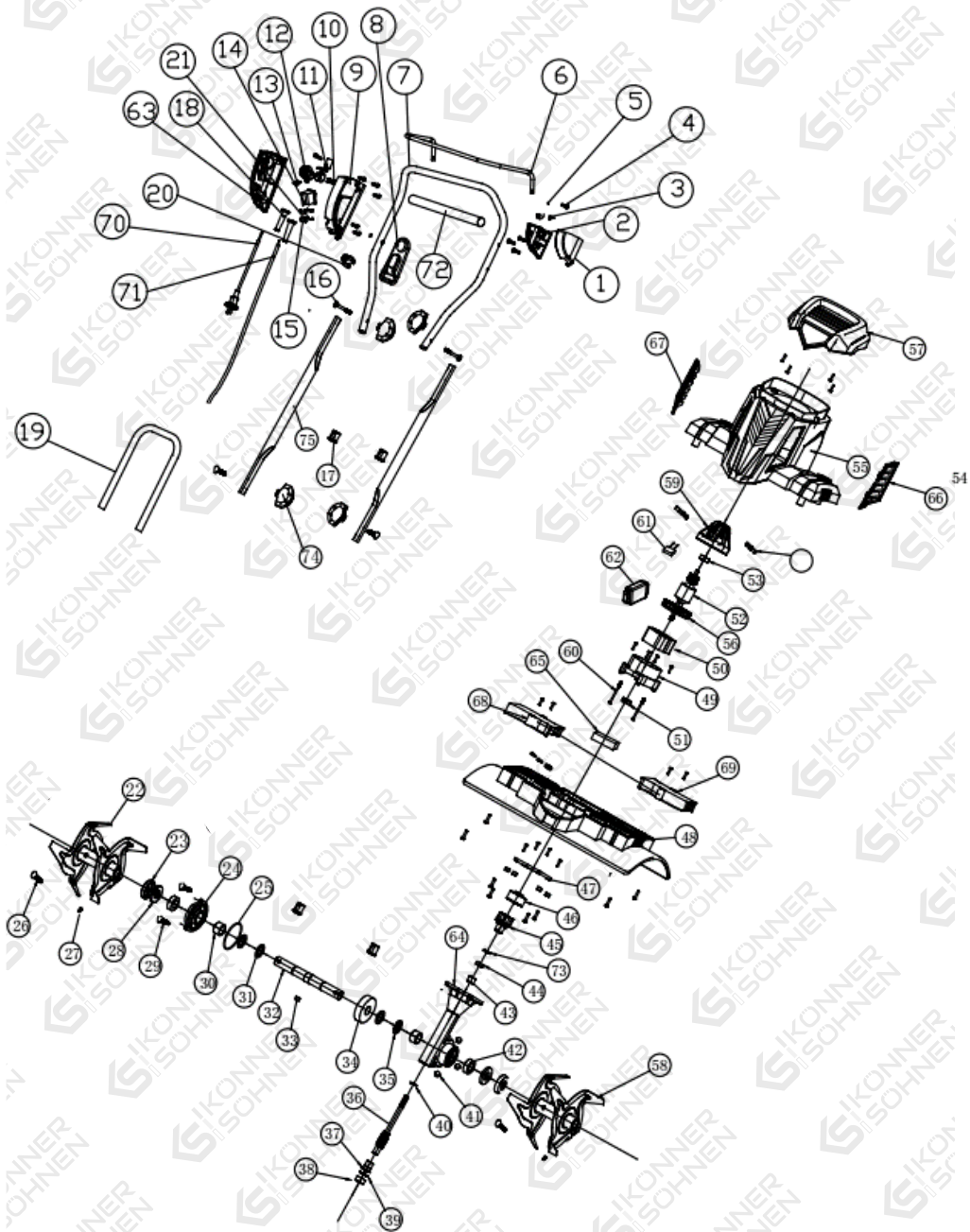

No	REF. No	DESCRIPTION	QTY
1	KS 1000T E-1	Left lower switch box	1
2	KS 1000T E-2	Left upper switch box	1
3	KS 1000T E-3	Trigger spring	1
4	KS 1000T E-4	Screw M4*10	2
5	KS 1000T E-5	Left trigger link	1
6	KS 1000T E-6	Switch trigger	1
7	KS 1000T E-7	Upper angle branch	1
8	KS 1000T E-8	Hanging buckle	1
9	KS 1000T E-9	Right lower switch box	1
10	KS 1000T E-10	Switch button spring	1
11	KS 1000T E-11	Right trigger linkage	1
12	KS 1000T E-12	Switch button	1
13	KS 1000T E-13	Tension spring	1
14	KS 1000T E-14	Switch	1
15	KS 1000T E-15	Pressing line plate	3
16	KS 1000T E-16	Bolt	4
17	KS 1000T E-17	Plastic end cap	4
18	KS 1000T E-18	Cable sheath	2
19	KS 1000T E-19	Lower tube	1
20	KS 1000T E-20	Hanging buckle	1
21	KS 1000T E-21	ST4*16 screw	18
22	KS 1000T E-22	Right side of blade assembly	1
23	KS 1000T E-23	Lock washer	2
24	KS 1000T E-24	Gear box cover	1
25	KS 1000T E-25	O ring	1
26	KS 1000T E-26	Hexagon socket head cap screws M8*40	2
27	KS 1000T E-27	Lock nut M8	2
28	KS 1000T E-28	Woollen spacer	2
29	KS 1000T E-29	Screw M5*35	3
30	KS 1000T E-30	Axle sleeve	2

No	REF. No	DESCRIPTION	QTY
31	KS 1000T E-31	Shaft ring Ø20	2
32	KS 1000T E-32	Output shaft	1
33	KS 1000T E-33	Retainer	1
34	KS 1000T E-34	Spacer	1
35	KS 1000T E-35	Flat washer	2
36	KS 1000T E-36	Worm	1
37	KS 1000T E-37	O ring	1
38	KS 1000T E-38	Tap	1
39	KS 1000T E-39	O ring	1
40	KS 1000T E-40	Plane bearing	1
41	KS 1000T E-41	Lock nut M5	5
42	KS 1000T E-42	Oil seal 20*35*6	2
43	KS 1000T E-43	Needle bearing HK0912	2
44	KS 1000T E-44	Oil seal 9*18*6	1
45	KS 1000T E-45	Coupling A	1
46	KS 1000T E-46	Coupling B	1
47	KS 1000T E-47	Connector	1
48	KS 1000T E-48	Housing base	1
49	KS 1000T E-49	Lower motor housing case	1
50	KS 1000T E-50	Stator	1
51	KS 1000T E-51	Bearing 609	1
52	KS 1000T E-52	Rotor	1
53	KS 1000T E-53	Bearing 608	1
54	KS 1000T E-54	Carbon bush	2
55	KS 1000T E-55	Middle housing case	1
56	KS 1000T E-56	Fan	1
57	KS 1000T E-57	Upper housing case	1
58	KS 1000T E-58	Left side of blade assemblby	1
59	KS 1000T E-59	Upper motor housing case	1
60	KS 1000T E-60	Screw M5*65	2

No	REF. No	DESCRIPTION	QTY
61	KS 1000T E-61	Capacitor	1
62	KS 1000T E-62	Inductor	2
63	KS 1000T E-63	Right upper side switch box	1
64	KS 1000T E-64	Gear box	1
65	KS 1000T E-65	Electric resistance	2
66	KS 1000T E-66	Left decoration	1
67	KS 1000T E-67	Right decoration	1
68	KS 1000T E-68	Left baffle	1
69	KS 1000T E-69	Right baffle	1
70	KS 1000T E-70	Cable plug	1
71	KS 1000T E-71	Connection line	1
72	KS 1000T E-72	Patch	1
73	KS 1000T E-73	Wool felt	2
74	KS 1000T E-74	Knob	2
75	KS 1000T E-75	Middle tube	1

! This material is for informational purposes only and is not an instruction. The connection of the equipment in each case must be performed by a certified electrician, in accordance with local laws and regulations. Before connecting, we urge you to read the recommendations in the manual for the generator. The manufacturer is not responsible for improper connection of equipment, and is not responsible for possible material and physical damage that may occur as a result of improper installation, connection or operation of equipment.

CONTACTS

konner-sohnen.com

Germany

info@dimaxgroup.de

Poland

info.pl@dimaxgroup.de

Ukraine

sales@ks-power.com.ua